

WIRELESS AUDIO TRANSMISSION TFM OPERATION MANUAL

Tanglewood®

PRECAUTIONS

Location

Using the product in the following locations could result in a malfunction:

- Locations of extreme temperature or humidity
- Excessively dusty or dirty locations
- Locations of excessive vibration
- Locations near to magnetic sources

Battery maintenance

When there is a low battery alarm, please charge the product as soon as possible. The internal lithium battery cannot be stored without power, which will seriously affect the service life of the battery.

Handling

To avoid breakage, please do not apply excessive force to the switch buttons or other controls.

Care

Do not set any container with liquid close to the transmitter or receiver, if liquid gets into the transmitter or receiver it is likely to break or in some cases cause fire or electric shock.

Keep other things out of your product

Do not set any container with liquid in it close to this machine. If liquid gets into the machine, it may cause a breakdown, fire, or electrical shock.

Keep this owner's manual

After reading this manual, please keep it for later reference.

MAIN FEATURES

This wireless transmission system consists of two parts TFM TRANSMITTER and TFM RECEIVER, uses UHF technology

Suitable for multiple instruments

The transmitter comes with a 3.5mm connector and a 6.35mm detachable adapter, which is compatible with all kinds of electro-acoustic instruments with the ability to rotate, and can be used for different interface positions.

7 channel connectivity

7 Channels built in to give flexibility to connect to multiple receivers .

Anti-interference UHF frequency offers a high quality stable long distance signal without compression or distortion.

Large Battery Capacity

The TFM comes with a large capacity 950mA rechargeable Li battery for up to 6hours of use.

PARTS AND FUNCTIONS

1. 6.35mm+3.5mm audio jack (TRANSMITTER)
6.35mm audio jack (RECEIVER)
2. Channel indicator (7 colours for 7 channels)
3. Power indicator
4. Press and hold to turn ON/OFF, short press to switch channel
(Special note: See POWER SAVING mode-power indicator)
5. Type-C charging jack.

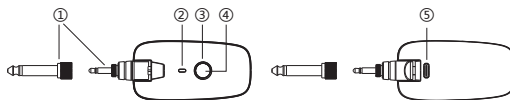

ONE TRANSMITTER TO ONE RECEIVER

ON/OFF

Hold down power button for 2 seconds, the power indicator light will turn on

Match/Pair

Once the device is powered on, it will automatically match. If the button is pressed in error while using the device, you can short press with the transmitter or receiver button to switch and rematch. Alternatively you can power off the device and power on again to match automatically.

Switch channel

Once matched you can switch channels with a short press of the button. Note: If the indicator light is flashing on the transmitter the match has been unsuccessful.

MULTIPLE TRANSMITTERS TO MULTIPLE RECEIVERS

With 7 channels the TFM can be used alongside multiple sets at the same time, when doing this ensure that each set is matched on a separate channel, for example one transmitter and receiver are both red and another set is blue as shown in the below diagram.

Notice: If two sets are matched on the same frequency it will cause feedback and distortion.

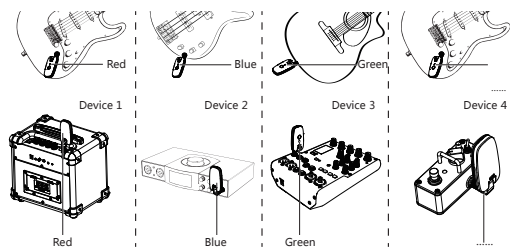

Tip: When installing the receiver unit ensure it is positioned vertically to offer the very best transmission.

ONE TRANSMITTER TO MULTIPLE RECEIVERS

To connect one transmitter to multiple receivers, simply turn on the transmitter and all receivers, the connection will automatically match. If the receivers are already on and matched to a single colour simply switch the transmitter channel to match.

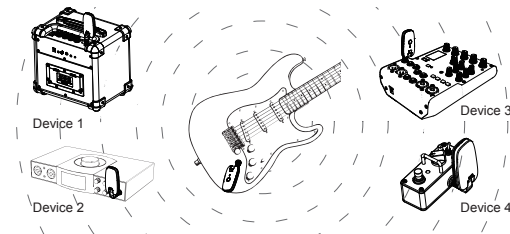

CHARGING AND POWER INDICATION

Please use the USB cable provided for charging.

Charging

When charging the power indicator light will flash

When fully charged the power indicator light will remain solid

Battery Charge

Power more than 60% indicator light will be solid

Power between 30-60% indicator light will flash slow

Power between 5-30% indicator light will flash fast

Power less than 5% indicator will flash fast for 5 secs and then turn off

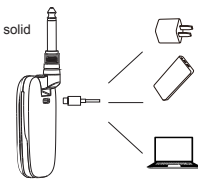

Notice: To save power indicator light will only display for 30secs once turned on, it will alight every 5mins to show the power remaining for 30secs each time. If charge is below 30% the power indicator will remain on. Once the power indication light has turned off when using the transmitter the first press will turn the indication light on and the second will switch channels.

POWER SAVING MODE

The transmitter and receiver will automatically turn off if no signal or input is detected for 30 minutes

SPECIFICATIONS

Power: 3.7V/950mA Polymer lithium battery

Channel: 7

Distance: 30-50m

Frequency: 863Hz - 865KHz

Dynamic range: > 106dB

Signal-to-noise ratio: > 85dB

Working time: approx 6 hours

Charging time: approx 2 hours

Dimension: 37.2 × 73.2 × 26.5mm

Weight: 93g

Accessories: User manual, Type-C USB cable

FCC Warning:

This equipment has been tested and found to comply with the limits for a Class B digital device, pursuant to part 15 of the FCC Rules. These limits are designed to provide reasonable protection against harmful interference in a residential installation. This equipment generates, uses and can radiate radio frequency energy and, if not installed and used in accordance with the instructions, may cause harmful interference to radio communications. However, there is no guarantee that interference will not occur in a particular installation. If this equipment does cause harmful interference to radio or television reception, which can be determined by turning the equipment off and on, the user is encouraged to try to correct the interference by one or more of the following measures: Reorient or relocate the receiving antenna.

• Increase the separation between the equipment and receiver.

• Connect the equipment into an outlet on a circuit different from that to which the receiver is connected.

• Consult the dealer or an experienced radio/TV technician for help.

Caution: Any changes or modifications to this device not explicitly approved by the manufacturer could void your authority to operate this equipment. This device complies with part 15 of the FCC Rules. Operation is subject to the following two conditions: (1) This device may not cause harmful interference, and (2) this device must accept any interference received, including interference that may cause undesired operation.

This equipment complies with FCC radiation exposure limits set forth for an uncontrolled environment. This equipment should be installed and operated with minimum distance 20cm between the radiator & your body.